

	L	D	d
625SV-TVK	40	16	9.3
1650SV-TVK	55	21	11
2595SV-TVK	55	25	14
25185SV-TVK	80	35	21
SE25150T-V-K	70	26.5	-
SE150300V-K	109	38	-
1070/MS-SCW	40	16	10.5

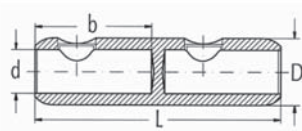

	L	D	d	b
M16-95	70	24	12.5	32
M50-150	85	30	15.5	35
M95-240	120	33	20	56
M120-300	142	38	25	67
M185-400	170	42	26	82
M400-630	200	54	34	94
M50-150/16-95	85	30	15.5/12.5	35/32
M120-300/16-95	142	38	25/12.5	67/32

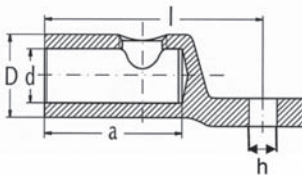

	L	D	d	a	h	Palm Width
C16-95	60	24	12.5	32	13	30
C50-150	65	30	15	35	13	30
C95-240	90	33	20	56	13	33
C120-300	100	38	25	67	13	38
C185-400	115	42	26	82	13	42
C400-630	130	52	34	94	13	52
1070/MS-SCW	39	16	10.5	20	10.5	20